

DIMENSIONS

	2-1/2"	3"	4"
A	32-1/4	33-1/2	36-3/4
B	17	17	18-1/2
C (NRS)	21-1/2	22-1/4	23
C (OS&Y) OPEN	30-1/2	32	32-3/4
D (NRS)	12	12-3/4	13-1/2
D (OS&Y) OPEN	21	22-1/2	23-1/4
E	9-1/2	9-1/2	9-1/2
F	12	12-1/4	12-1/2
G	7	7-1/2	9
H	27	28	31-1/2
I	36-1/2	38	41-1/2
J	21	22	23-3/4
K	27	29	32
Test Cocks	1/2 NPT	1/2 NPT	1/2 NPT
Net Wt. (Less Gate Valves)	100	102	112
Net. Wt. (w/NRS Valves)	195	228	298
Net. Wt. (w/OS&Y Valves)	206	236	310
Shpg. Wt. (Less Gate Valves)	164	166	176
Shpg. Wt. (w/NRS Valves)	263	296	368
Shpg. Wt. (w/OS&Y Valves)	273	303	382

Weights are without elbows

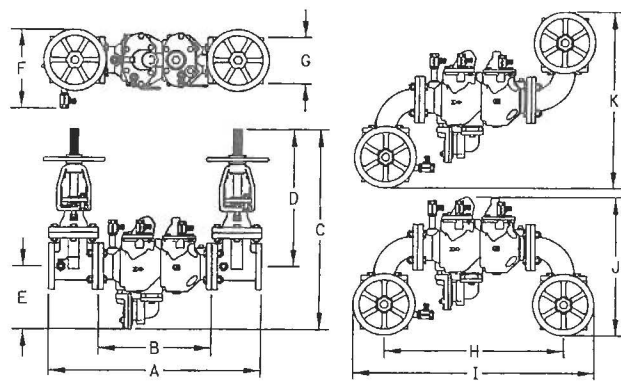

Relief Valve Parts

ITEM	DESCRIPTION	2-1/2", 3", 4"
1	Plug	K-3019-00
2	3/8 x 1" HHC Screw	B-1792-00
4	Relief Valve Cover Plate	Q-5782-05
5	Relief Valve Diaphragm	D-2515-00
8	Relief Valve Sub-Assembly	W-6622-05
9	1/4-20 x .5" PHM Screw	B-1753-00
10	Diaphragm Plate	D-2516-00
11	Relief Valve Spring	A-1702-00
12	Relief Valve Bushing	I-4257-15
13	Relief Valve Bushing O-ring	D-2512-00
14	Relief Valve Stem	G-3213-00
15	Relief Valve Stem O-ring	D-2513-00
16	Relief Valve Seat Disc	D-2514-00
17	Relief Valve Seat Washer	D-2499-00
18	Relief Valve Seat	L-4867-00
19	Relief Valve Seat O-ring	D-2274-00
20	Relief Valve Body	Q-5783-05
21	1/2-13 x 1.25" HHC Screw	B-2550-00

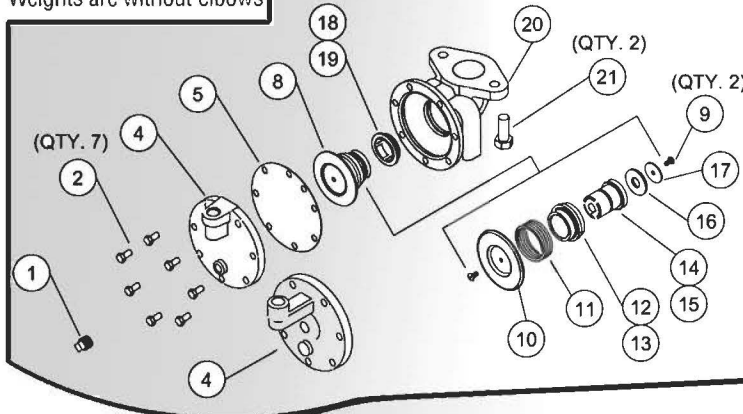

MODEL RP

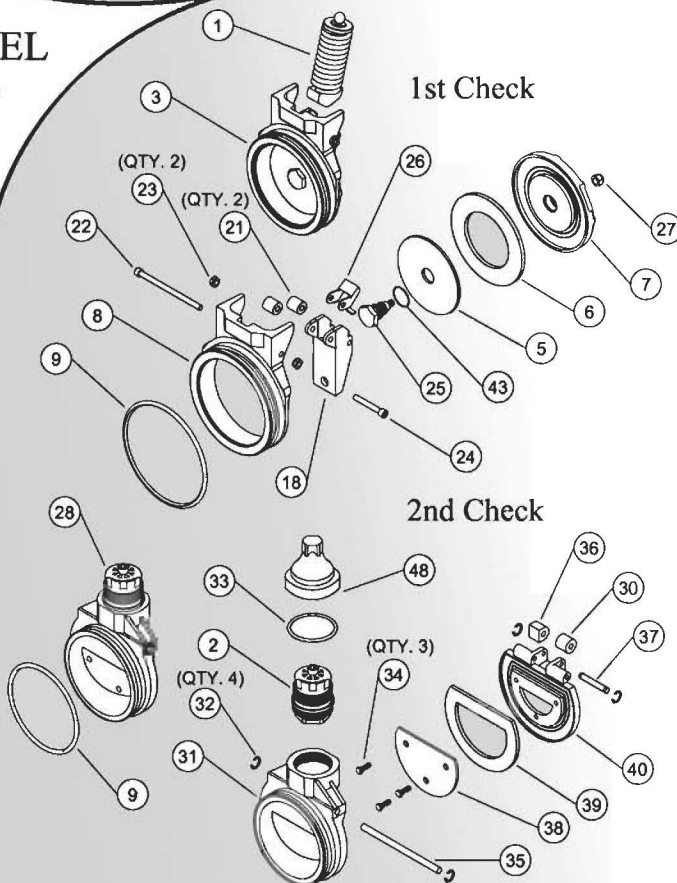

1st & 2nd Check Valve Parts

ITEM	DESCRIPTION	2-1/2", 3", 4"
1	First Check Spring Assembly	W-4537-05
2	Second Check Spring Assembly	W-8393-00
3	First Check Assembly	W-4538-05
5	Disc Plate	E-2538-00
6	Seat Disc	D-4011-00
7	Clapper	F-3226-05
8	First Check Seat Housing	F-3227-05
9	Seat O-ring	D-3507-00
18	First Check Swing Arm	G-3950-05
21	First Check Roller	I-6476-00
22	1/4-20 x 4" HHC Screw	B-2252-00
23	1/4 Lock Nut	C-1900-00
24	1/4-20 x 1.75" HHC Screw	B-2286-00
25	Center Bolt	B-2544-06
26	Positioning Bracket	I-6480-00
27	5/16 Lock Nut	C-2052-00
28	Second Check Assembly	W-7590-05
30	Second Check Roller	I-5866-00
31	Second Check Seat Housing	F-3090-00
32	Retaining Ring	I-3144-00
33	Spring Cap O-ring	D-3506-00
34	1/4-20 x .75" HHC Screw	B-1793-00
35	Hinge Pin	I-5868-06
36	Hinge Bushing	D-3685-00
37	Roller Pin	I-5867-05
38	Disc Plate	E-2379-00
39	Seat Disc	D-3504-00
40	Clapper	G-3769-00
43	Center Bolt O-ring	D-2578-00
48	Spring Cap	S-4877-00